

Courses and distances
down the River

- S. 20 W. 70 perches
- N 85 W. 140
- N 32 W. 40.
- N 54 W. 28
- N 65 W. 34
- S. 87 W. 26
- S. 19 W. 16
- S. 18 E. 18
- S. 43.8
- S. 57 E. 40
- S. 61 E. 46
- S. 40 E. 44
- S 56. E. 34
- S. 26. E. 20
- S 53 E. 26
- S 20 E. 24
- South 40.7
- S 0 33 W. 30
- S. 63 W. 166
- N. 77. W. 86
- N. 35 W. 78
- N. 75 W. 78 To a Post on bank of River

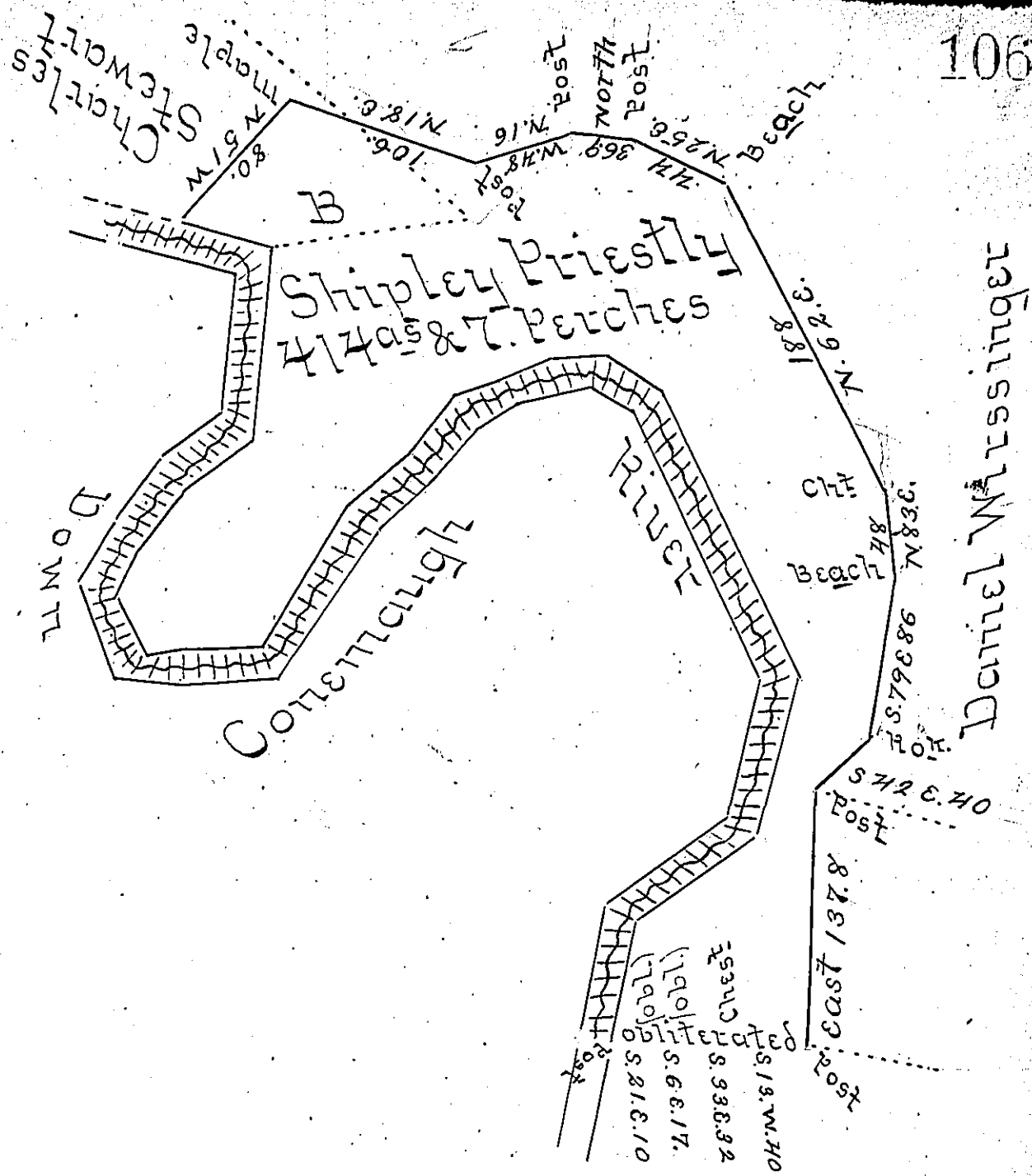

Situate on the South Side of Conemaugh River in Conemaugh Township Cambria County Containing 4149s & 7^{ths} with the usual allowance of six per cent for Roads &c. Resurveyed and corrected on the ground in August 1841 and found all the above lines well marked at the date of the original survey except along the River but the Courses did not agree with the Official Copy of Draft as will be seen, Resurveyed in pursuance of a Warrant dated 2^d December 1830 granted to Shipley Priestly, the part marked B Shows the interference with C.S. Stewart

To Jacob Salledo Esq: Secy John Mageehan J.S. of Cambria County

IN TESTIMONY that the above is a copy of the original remaining on file in the Department of Internal Affairs of Pennsylvania, made conformably to an Act of Assembly approved the 16th day of February, 1833, I have hereunto set my Hand and caused the Seal of said Department to be affixed at Harrisburg, this fourth day of August 1903.

James R. Brown
Secretary of Internal Affairs.